

OLIVE

 Total surface area - 30.66 m²

 Usable surface area - 22.15 m²

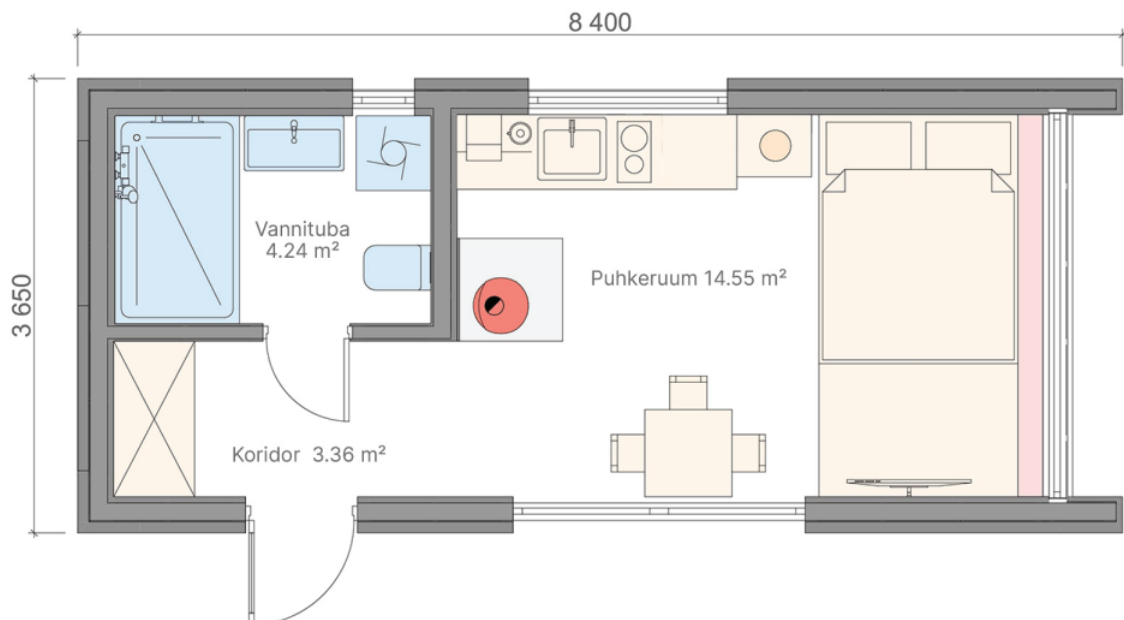

Exterior walls

- 1 Exterior cladding: Pine board, painted 20 mm.
Textured cover / Trapezoidal profile T-8
- 2 Treated with bio wood preservative:
Horizontal pine timber beam 30×70 mm
- 3 Treated with bio wood preservative:
Vertical pine timber beam 30×70 mm
- 4 Windbreak board; Density: 90 g/m²
- 5 OSB-3 board 10 mm
- 6 Insulation: Mineral wool in the cross-section of the frame 150 mm,
thermal conductivity: 0.037 W/mK
- 7 Frame: Pine wood 50×150 mm,
treated with bio wood preservative
- 8 Vapor barrier film; Density: 110 g/m²
- 9 Treated with bio wood preservative:
Vertical pine timber beam 30×70 mm
- 10 Textured with coating. Pine wood cladding thickness 20 mm,
painted, treated with bio wood preservative



Floor



- 1 Rooms and corridor
Washroom: ceramic tile
- 2 Rooms and corridor: OSB-3 board 22 mm
Washroom: OSB-3 board 10 mm + Cement particle board 12 mm
- 3 Vapor barrier film; Density: 110 g/m²
- 4 Floor joists: pine timber beam 50×200mm
- 5 Insulation in floor joists: mineral wool 200 mm,
treated with bio wood preservative
- 6 Wind barrier board; Density: 90 g/m²
- 7 OSB-3 board 10 mm
- 8 Base waterproofing layer of the house

Roof

- 1 Trapezoidal profile T-147
- 2 Horizontal pine timber beam 30×70 mm,
with textured coating
- 3 Vertical pine timber beam 30×70 mm,
treated with bio wood preservative
- 4 Moisture permeability: 1300 g/m² in 24 hours
- 5 Insulation between rafters: mineral wool 200 mm,
Thermal conductivity: 0.037 W/mK
- 6 Rafters: pine timber beam 50×200mm,
treated with bio wood preservative
- 7 Vapor barrier film; Density: 110 g/m²
- 8 Vertical pine timber beam 30×70 mm,
treated with bio wood preservative
- 10 Pine cladding 20 mm thick, painted and treated
with bio wood preservative



Equipment

Frame and insulation

North, frame of walls and ceiling: pine wood, dry, polished	✓
OSB board 22 mm for laminate base	✓
OSB board 10 mm for reinforcing the frame of exterior walls	✓
Floor insulation / thickness of floor construction	200 mm / 240 mm
Floor insulation / thickness of floor construction	200 mm / 340 mm
Ceiling insulation / thickness of ceiling/roof construction	150 mm / 285 mm
Exterior wall insulation / thickness of interior walls	150 mm / 135 mm

Exterior finishing

Exterior facade: pine board/metal	✓
Roof: metal profile; Gutter system: metal	✓

Interior finishing

Flooring in rooms	Water-resistant laminate
Flooring in washroom	Ceramic tile
Finishing of interior walls and ceiling	Knotless pine wood cladding

Bathroom

Shower	The shower area is surrounded by ceramic floor tiles. The walls are designed for water drainage and are made of glass. It is slightly sloped to facilitate drainage.
Toilet	Compact floor toilet
Sink 600×440 mm with cabinet	✓
Mirror	600×800 mm with lighting

Electricity

Wiring, electrical panel with automation, external and internal lights, sockets, switches	✓
---	---

Heating

Sockets for connecting heaters in every room	✓
Forced ventilation in the bathroom	✓

Water supply and sewage

All necessary pipes installed	✓
Water heating boiler with a capacity of 50 liters	✓

Ventilation

Kitchen ventilation duct for hood installation	✓
Forced extraction ventilation in the bathroom	✓

